

# SPIDER

BANNER STANDS-Pg.1

Your Spider will arrive with these parts.

1. A Retractable Banner Stand Base, referred to as the RBS.
2. Three Adjustable Banner Stand Poles.  
The top pole has a fixed plastic cap for the Banner Graphic Attachment Rod.  
The two adjoining telescoping poles are the base poles.
3. A Top Banner Graphic Attachment Rod.



**Important:** The graphic should be attached before the pin is removed!

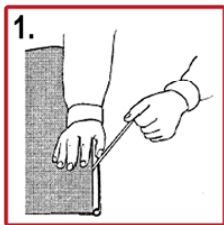

1. **Always make sure the surface is clean.**  
First place the image (picture side up) to the top profile.  
Then remove the protective strip from the adhesive strip.

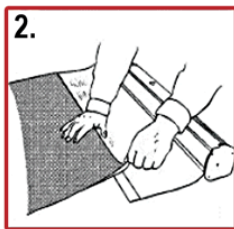

2. Next apply the image with the picture side facing up and press the graphic firmly to the adhesive strip.  
**Be sure to follow the tape line.**

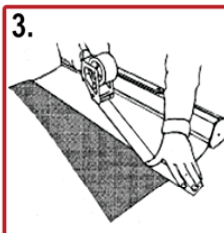

3. **IMPORTANT!**  
To secure the image apply packaging tape over the joint on both sides of the assembly.

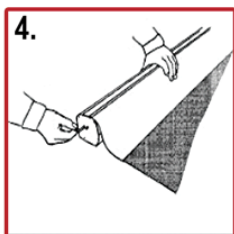

4. Grip the image with the left hand, and remove the locking pin with the right hand.  
**THE SPRING IS NOW ACTIVATED!**

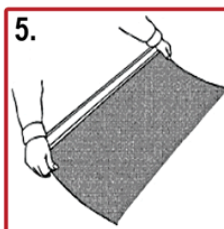

5. Now carefully let the image roll into the unit.

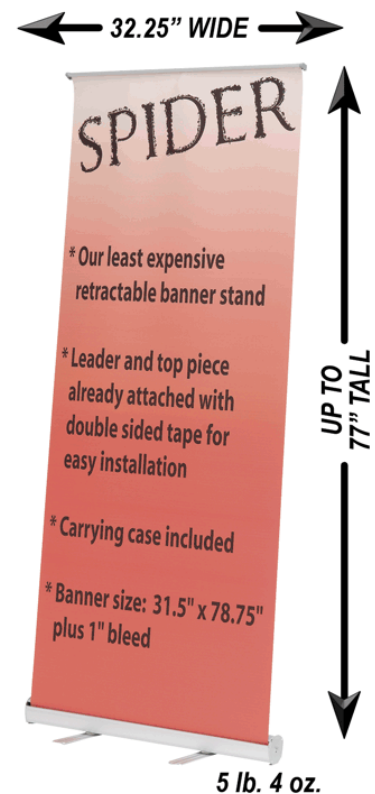

Changing the image:

- A. Locate the locking pin
- B. Pull out the image as far as possible
- C. Adjust length, so that the locking pin fits into the hole on the side of the banner stand.
- D. **Important** -- Lock the mechanism with the locking pin.
- E. Remove old image.

# SPIDER

BANNER STANDS Pg.2

**Important:** The graphic should be attached before installation of the pole system!

6.



6. Adjust the feet on the RBS unit to a 90° angle.

7.



7. Next connect the three telescoping poles by squeezing the poles beneath the plastic rings.

8.

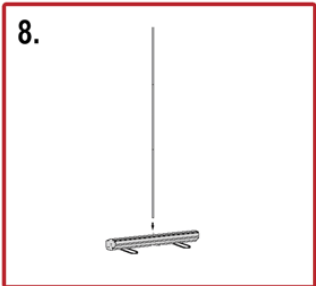

8. Next connect the three telescoping poles into the slot on the RBS unit and adjust the telescoping poles to the desired height. **Remember, in order to tighten the telescoping poles, grip the supporting base pole while twisting the top into the supporting pole using a clockwise motion.**

9.

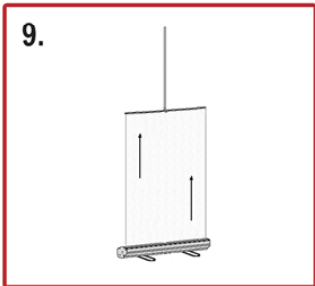

9. Using two hands pull the banner to the desired height.

10.



10. Attach the top bar to the slotted cap on the top telescoping pole. It might be easier to lean the stand backwards while attaching the banner.



Ph: 1-800-654-8405 Fax: 1-888-405-4548  
sales.service@fellers.com